

The Robin B
- Side Load Garage -

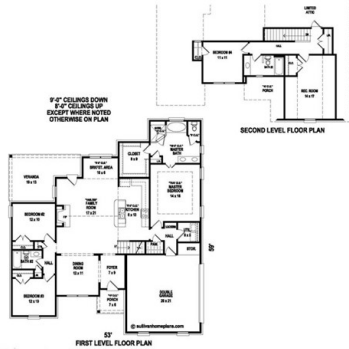

MLS United LLC

ENTRANCE CONCEPTUAL, ALL OTHERS
DESIGNED BY CHANGING
ARCHITECTURE 10-20-20

\$ 434,990

The Robin B

- Side Load Garage -



The Robin B

- Side Load Garage -

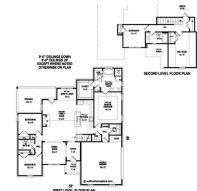

MLS United LLC



MLS United LLC



5332 John Neilson Way, Olive Branch, MS 38654

- » Beds: 5 | Baths: 3 Full
- » MLS #: 4110586
- » Single Family | 2,400 ft² | Lot: 35,284 ft² (0.81 acres)
- » More Info: [5332JohnNeilsonWayOliveBranch.IsForSale.com](https://www.5332JohnNeilsonWayOliveBranch.IsForSale.com)



Jennie Holliday

(901) 334-6961 (mobile)

(662) 548-2000 (office)

holliday@collins-maury.com

<https://www.hollidaysellshomes.com>



Coldwell Banker Collins-Maury

3276 Goodman Rd E

Southaven, MS 38672

(662) 548-2000

Come home to the Robin B model - an inviting open concept, 5 bedroom, 3 full bath home situation on a corner lot in the very desirable Southbranch Subdivision. This lovely new home is within walking distance of Pleasant Hill Elementary School. Don't wait! Come see us at the model home Mon., Thurs., Fri., & Saturday 1 - 6 p.m. or on Sun. 2 - 5. Or schedule your private appointment anytime. PHOTOS ARE SAMPLE ONLY and are of a similar Robin A model. Finishes will vary.

